

H3035-H3036

VALVOLE A SFERA IN OTTONE CON MANIGLIA A FARFALLA

BRASS BALL VALVES WITH BUTTERFLY HANDLE



CARATTERISTICHE TECNICHE

// Corpo valvola:

ottone conforme a UNI-EN 12165

// Tenuta sfera: PTFE

// Attacchi filettati: gas UNI ISO 228/1

// Pressione nominale di esercizio: 25 bar

// Temperatura di esercizio: -20°C – +90°C

TECHNICAL FEATURES:

// Body valve:

brass according to UNI-EN 12165

// Ball seats: PTFE

// Threaded ends:

gas according to UNI ISO 228/1

// Maximum working pressure (PN): 25 bar

// Working temperature: -20°C – +90°C

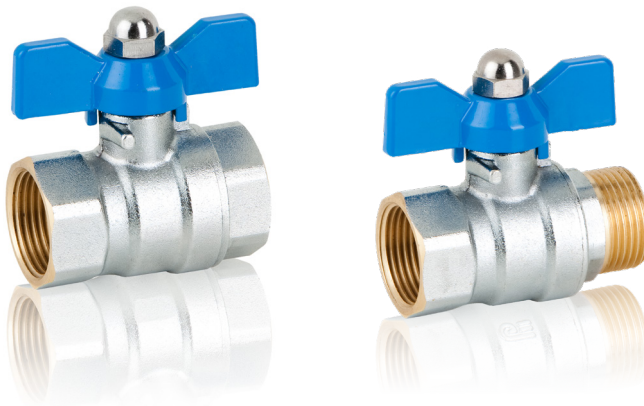

VERSIONE FEMMINA - FEMMINA // FEMALE - FEMALE MODEL

DIMENSIONI E PESI // DIMENSIONS AND WEIGHTS

Misura Size	PN	Dimensioni in mm // Dimensions in mm				Peso in gr Weight in gr
		P	A	L	M	
1/4"	10	10	38	40	50	90
3/8"	10	10	38	43	50	100
1/2"	15	14	40	49	50	145
3/4"	20	19	50	56	62	240
1"	25	24	53	68	62	360

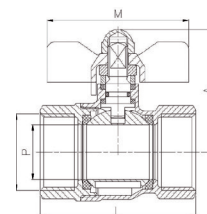

VERSIONE MASCHIO - FEMMINA // MALE - FEMALE MODEL

DIMENSIONI E PESI // DIMENSIONS AND WEIGHTS

Misura Size	PN	Dimensioni in mm // Dimensions in mm				Peso in gr Weight in gr
		P	A	L	M	
1/4"	10	10	38	48	50	100
3/8"	10	10	38	49	50	105
1/2"	15	14	40	56	50	150
3/4"	20	19	50	64	62	250
1"	25	24	53	76	62	380

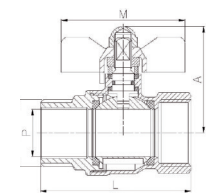

CARATTERISTICHE COSTRUTTIVE // CONSTRUCTION FEATURES

	Componenti // Components	Materiale // Material
1	Corpo // Body	Ottone cromato // Chromed brass
2	Coperchio // Cap	Ottone cromato // Chromed brass
3	Sfera // Ball	Ottone cromato // Chromed brass
4	Albero // Stem	Ottone cromato // Chromed brass
5	Tenuta sfera // Ball seats	PTFE
6	Anello di giuntura // Stem packing	PTFE
7	Guarnizione // O-Ring	NBR
8	Guarnizione albero // Stem ring	Ottone cromato // Chromed brass
9	Dado // Nut	Ottone cromato // Chromed brass
10	Maniglia // T-Handle	Alluminio verniciato // Painted aluminium
11	Dado // Nut	Ottone cromato // Chromed brass

