

H2118

**Valvole a sfera
tipo wafer / Wafer
ball valves**

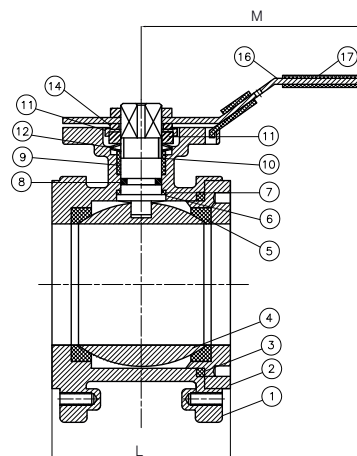

Modello / Model
H2118

Materiale / Material
Aisi 316

Tenuta / Seal
PTFE + 15% FV / GF

DN
15 – 100

PN
16

Caratteristiche tecniche / Construction features

- **Montaggio diretto attuatore secondo /**
Direct actuator installation according to
ISO 5211
- **Montaggio tra flange secondo /** Assembly
between flanges according to
EN 1092 PN16
- **Pressione nominale di esercizio /**
Nominal working pressure
16 bar
- **Temperatura di esercizio /** Working
temperature
-20°C – +180°C
- **Albero anti-espulsione /**
Blow-out proof stem

Diagramma pressione temperatura / Pressure temperature diagram

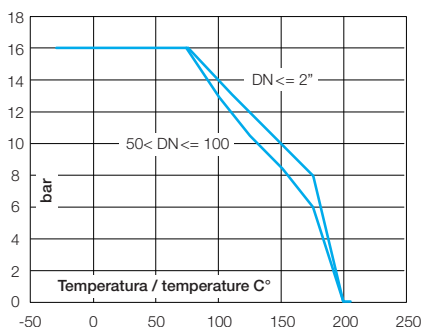

Componenti e materiali / Components and materials

1	Corpo / Body	Acciaio Inox Aisi 316 / SS Aisi 316
2	Tappo / Cap	Acciaio Inox Aisi 316 / SS Aisi 316
3*	Tenute / Gasket	PTFE
4	Sfera / Ball	Acciaio Inox Aisi 316 / SS Aisi 316
5*	Tenuta sfera / Seat ball	PTFE + 15% Fibra di vetro / PTFE + 15% Glass fiber
6	Albero / Stem	Acciaio Inox Aisi 316 / SS Aisi 316
7*	Rondella / Trust Washer	PTFE
8*	Anello OR / O-ring	FPM
9*	Pacco albero / Stem packing	PTFE
10	Anello albero / Stem ring	Acciaio Inox Aisi 304 / SS Aisi 304
11	Dado / Nut	Acciaio Inox Aisi 304 / SS Aisi 304
12	Rondella molla / Spring washer	Acciaio Inox Aisi 304 / SS Aisi 304
13	Antisvitamento / Lock washer	Acciaio Inox Aisi 304 / SS Aisi 304
14	Rondella / Washer	Acciaio Inox Aisi 304 / SS Aisi 304
15	Fermo corsa / Stop pin	Acciaio Inox Aisi 304 / SS Aisi 304
16	Maniglia / Handle	Acciaio Inox Aisi 304 / SS Aisi 304
17	Coprimaniglia / Handle Sleeve	Vinile / Vynil

* **Ricambi disponibili /** Spare parts

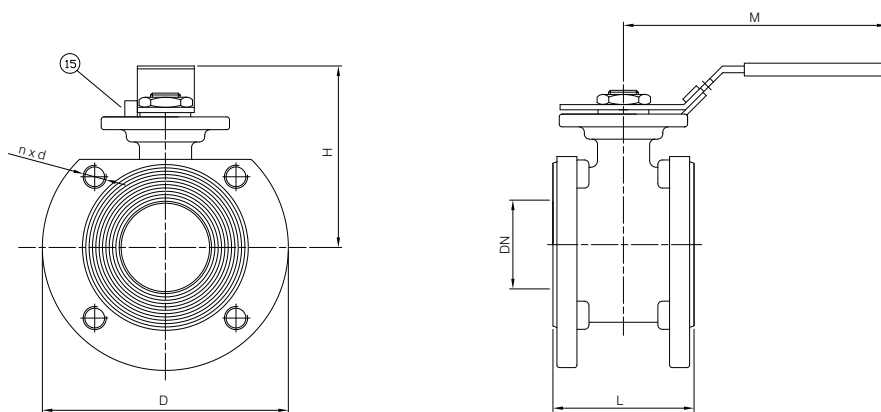

Dimensioni e pesi / Dimensions and weights

Codice Code	Misura Size	DN	PN	Peso in kg. Weight in kg.	KV m ³ /h	Dimensioni in mm Dimensions in mm					
						L	M	D	H	n x d	ISO 5211
H211804	1/2"	15	16	1,70	24	36	115	95	85	4 x M12	F-03/F-04
H211805	3/4"	20	16	1,90	43	38	115	105	90	4 x M12	F-03/F-04
H211806	1"	25	16	2,50	83	50	170	115	95	4 x M12	F-04/F-05
H211807	1" 1/4	32	16	3,50	130	53	170	140	100	4 x M16	F-04/F-05
H211808	1" 1/2	40	16	4,35	205	65	210	150	105	4 x M16	F-05/F-07
H211809	2"	50	16	5,45	340	78	210	165	115	4 x M16	F-05/F-07
H211810	2" 1/2	65	16	7,80	520	98	260	185	130	4 x M16	F-07/F-10
H211811	3"	80	16	10,30	1.100	118	260	200	145	8 x M16	F-07/F-10
H211812	4"	100	16	18,00	1.820	140	260	220	175	8 x M16	F-07/F-10