

90032

Valvole di ritegno a clapet / Swing check valves

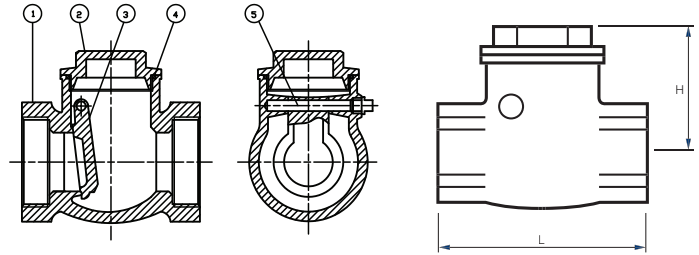

Modello / Model
90032

Materiale / Material
Aisi 316

Tenuta / Seal
PTFE

DN
15 – 50

PN
16

Caratteristiche tecniche / Construction features

- **Connessioni filettate femmina secondo /**
Female threaded ends according to
ISO 7-1 (EN 10226-1)
- **Pressione nominale di esercizio /**
Nominal working pressure
16 bar
- **Temperatura di esercizio /**
Working temperature
-25°C – +180°C
- **Installazione orizzontale o verticale /**
Installation horizontal or vertical flow

Componenti e materiali / Components and materials

1	Corpo / Body	Acciaio inox / Aisi SS 1.4408
	Trattamento superficiale / Surface treatment	Granigliatura / Shot blasting
2	Coperchio / Cap	Acciaio inox / Aisi SS 1.4408
	Trattamento superficiale / Surface treatment	Granigliatura / Shot blasting
3	Disco / Disc	Acciaio inox / Aisi SS 1.4408
4	Guarnizione / Seal ring	PTFE
5	Perno / Stem	Acciaio Inox Aisi 316 / SS Aisi 316

Diagramma pressione temperatura / Pressure temperature diagram

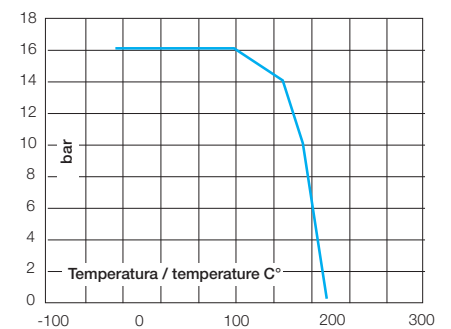

Dimensioni e pesi / Dimensions and weights

Codice Code	Misura Size	DN	PN	Peso in gr. Weight in gr.	KV m³/h	Dimensioni in mm Dimensions in mm	
						L	H
900320	1/2"	15	16	312	2.2	65	44
900321	3/4"	20	16	490	4.4	80	53
900322	1"	25	16	724	8.2	90	58
900323	1" 1/4	32	16	1.042	16.4	105	62
900324	1" 1/2	40	16	1.650	24.1	120	73
900325	2"	50	16	2.392	44,2	141	78

Perdite di carico / Friction losses diagrams

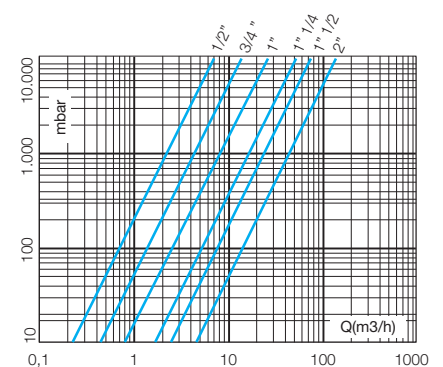

**Su richiesta /
On request**



Filettatura NPT / NPT thread