

H3023

Valvole a sfera in ottone con attacco diretto attuatore / Brass ball valves for direct actuator installation

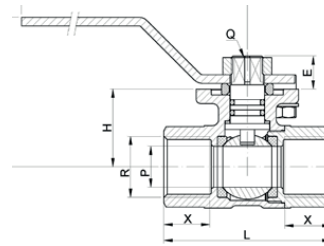
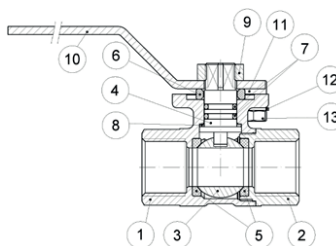
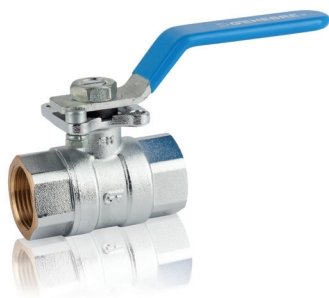

Modello / Model
H3023

Materiale / Material
Ottone / Brass

Tenuta / Seal
PTFE

DN
15 – 50

PN
40

Caratteristiche tecniche / Construction features

- **Montaggio diretto attuatore secondo /** Direct actuator connection according to ISO 5211
- **Connessioni filettate gas secondo /** Threaded ends gas according to ISO 228/1
- **Pressione nominale di esercizio /** Nominal working pressure 40 bar
- **Temperatura di esercizio /** Working temperature -20°C – +110°C

Diagramma pressione temperatura / Pressure temperature diagram

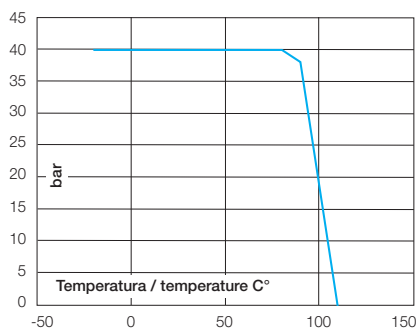

Componenti e materiali / Components and materials

1	Corpo / Body	Ottone cromato / Chromed brass
2	Chiusura / Cap	Ottone cromato / Chromed brass
3	Sfera / Ball	Ottone cromato / Chromed brass
4	Albero / Stem	Ottone cromato / Chromed brass
5	Tenuta sfera / Ball seats	PTFE
6	Anello / Ring	Nylon
7	Anello OR / O-ring	NBR
8	Anello / Ring	PTFE
9	Dado / Nut	Acciaio zincato / Zinc plated steel
10	Maniglia / Handle	Acciaio Dacromet / Dacromet steel
11	Vite Allen / Allen screw	Acciaio zincato / Zinc plated steel
12	Rondella / Grower washer	Acciaio zincato / Zinc plated steel
13	Dado / Nut	Acciaio zincato / Zinc plated steel

Dimensioni e pesi / Dimensions and weights

Codice Code	Misura Size	DN	PN	Peso in gr. Weight in gr.	KV m³/h	Dimensioni in mm Dimensions in mm						
						P	X	L	H	E	ISO 5211	Q
H302304	1/2"	15	40	274	16	14,3	15	58	27	11,5	F03	9
H302305	3/4"	20	40	376	30	19	16	65	32	11	F03	9
H302306	1"	25	40	564	45	23,8	19,5	78	35	11	F04	9
H302307	1" 1/4	32	40	927	70	30	19,5	88	43,3	13,5	F05	11
H302308	1" 1/2	40	40	1.254	115	37,3	24,6	105	48,8	13,5	F05	11
H302309	2"	50	40	1.886	210	46,5	26,5	122	60	13,8	F05	11