

M1

IDRJA / DN

Valvole di ritegno
in acciaio inox /
Stainless steel
check valves

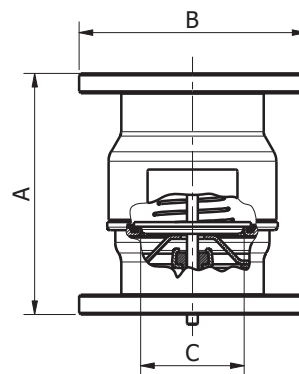
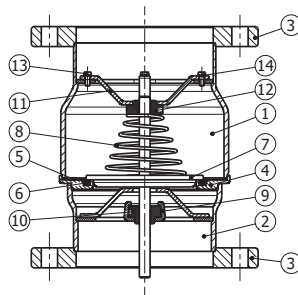

Modello / Model
IDRJA / DN

Materiale / Material
Aisi 316

Tenuta / Seal
FPM

DN
125 – 200

PN
16

Caratteristiche tecniche / Construction features

- **Lavorazione: acciaio inox stampato /**
Manufacturing process: pressed stainless steel
- **Trattamento superficiale sgrassaggio,
decapaggio ed elettrolucidatura /**
Surface treatment degreasing, pickling and
electropolishing
- **Tenuta / Seal ring**
FPM
- **Connessioni flangiate: flange in acciaio
inox con foratura secondo / Flanged ends:**
flanges in stainless steel with holes according to
UNI EN 1092-1 PN 16
- **Saldatura a TIG senza apporto di materiale**
TIG weldings without additional material
- **Pressione di apertura / Opening pressure**
Min. 0,035 – Max. 0,065 bar
- **Test idraulico di tenuta guarnizioni /**
Hydraulic test on the seal rings
0.2 bar
- **Pressione nominale di esercizio /**
Nominal working pressure
16 bar
- **Temperatura di esercizio / Working
temperature**
-20°C – +150°C

Componenti e materiali / Components and materials

1	Corpo valvola superiore / Upper valve body	1.4401
		1.4404 EN 10088
2	Corpo valvola inferiore / Lower valve body	1.4401
		1.4404 EN 10088
3	Flange / Flanges	1.4401
		1.4404 EN 10088
4	Coppa porta guarnizione / Seal ring housing	1.4401
		1.4404 EN 10088
5	Anello premi guarnizione / Seal ring retainer	1.4401
		1.4404 EN 10088
6	Guarnizione / Seal Ring	FPM
7	Otturatore / Flow control disc	1.4401
		1.4404 EN 10088
8	Molla / Spring	1.4401
		1.4404 EN 10088
9	Porta boccola inferiore / Lower bush holder	1.4401
		1.4404 EN 10088
10	Boccola inferiore / Lower guide bush	PTFE
11	Porta boccola superiore / Upper bush holder	1.4401
		1.4404 EN 10088
12	Boccola superiore / Upper guide bush	PTFE
13	Vite TE M5 x 12 / TE M5 x 12 screw	1.4401
		1.4404 EN 10088
14	Anello grower / Grower ring	1.4401
		1.4404 EN 10088

Diagramma pressione temperatura / Pressure temperature diagram

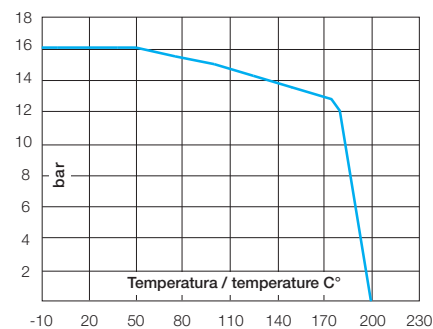

Perdite di carico / Friction losses diagrams

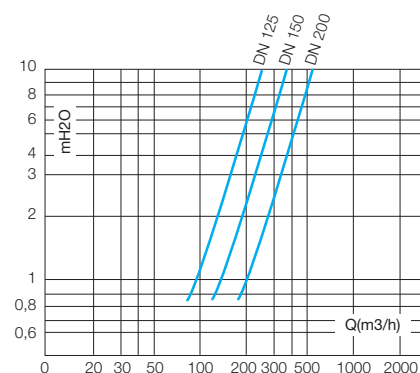

Dimensioni e pesi / Dimensions and weights

Codice Code	Misura Size	DN	Peso in kg. Weight in kg.	KV m³/h	Dimensioni in mm Dimensions in mm		
					A	B	C
900390	5"	125	18	260,16	266	Ø 250	Ø 114
900392	6"	150	24	325	284	Ø 285	Ø 146
900394	8"	200	36	525	318	Ø 340	Ø 188